

Bookshelf Lena

2 PERSON ASSEMBLY

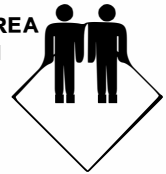

**FLOOR AREA
2.5M X 3M**



REQUIRED ASSEMBLY TOOLS

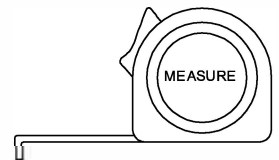
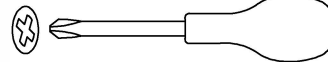
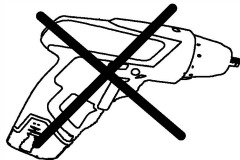

ASSEMBLED DIMENSIONS

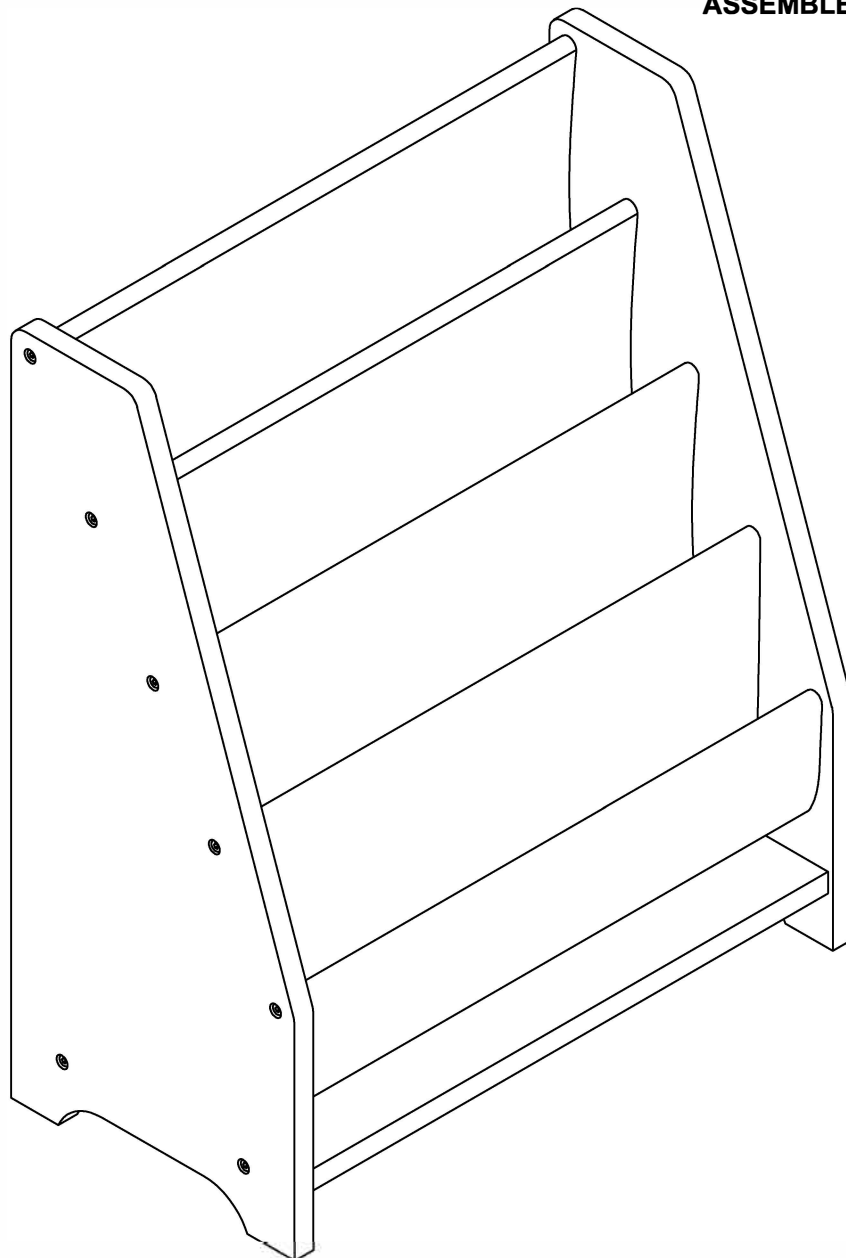

Bookshelf Lena

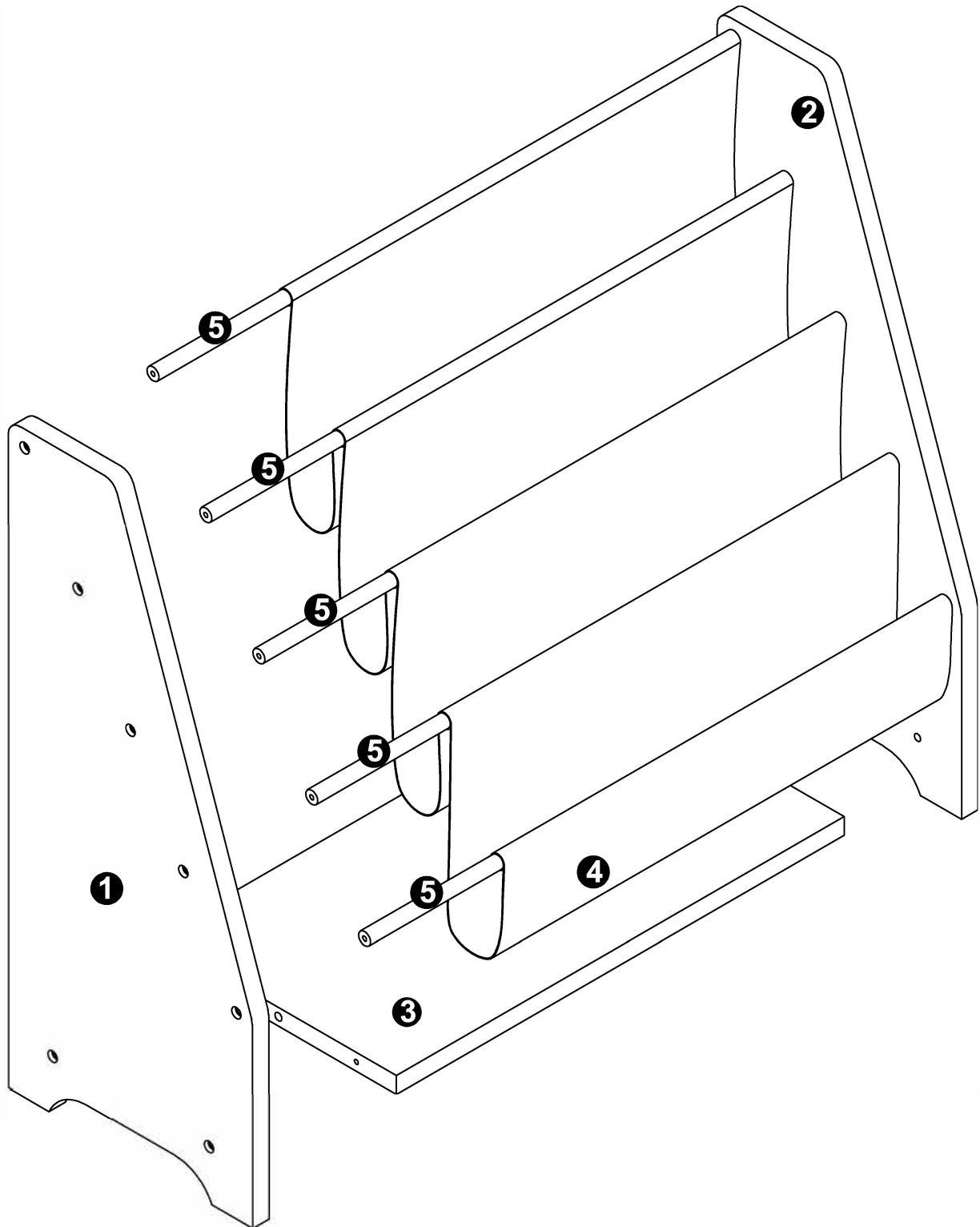

Bookshelf Lena

NO.	PARTS LIST	QTY	NO.	PARTS LIST	QTY
❶	Left side	1	❷	Fabric	1
❸	right side	1	❹	cross strut	1
❺	Bottom panel	1			

Bookshelf Lena

HARDWARE LIST

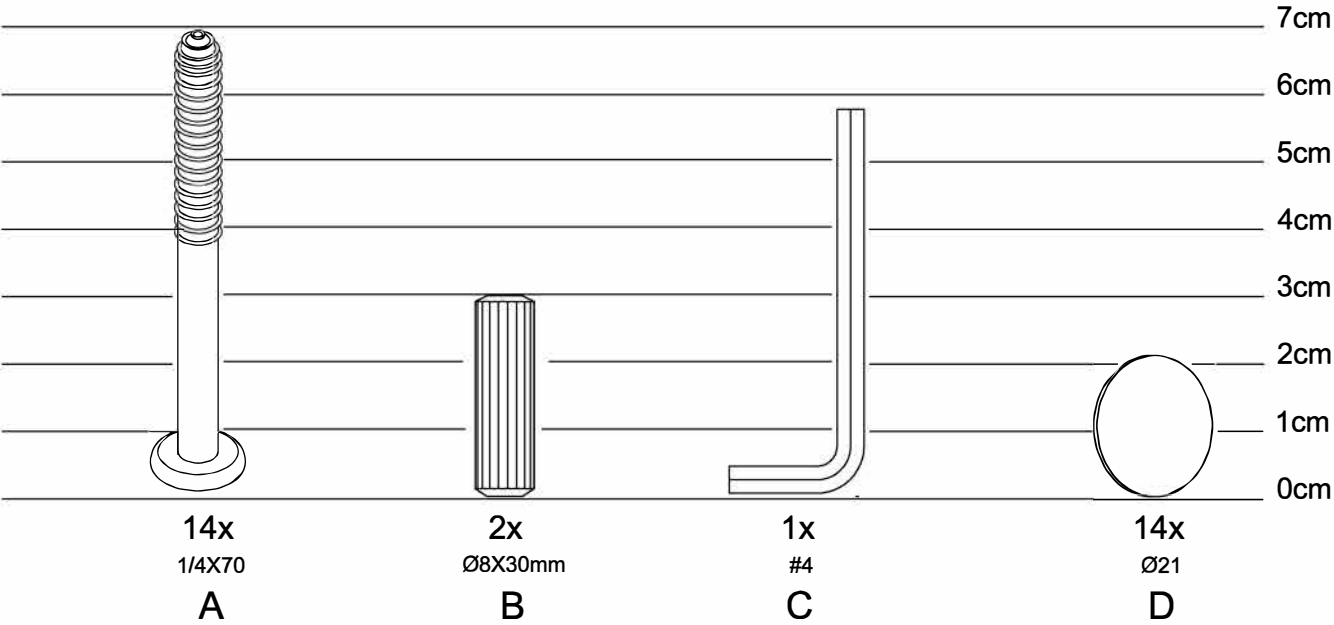

Bookshelf Lena

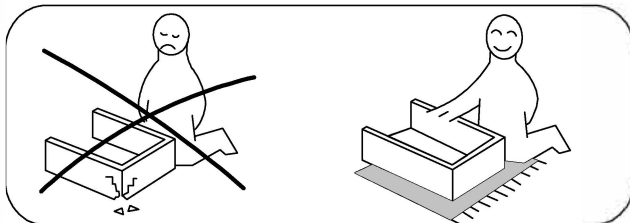
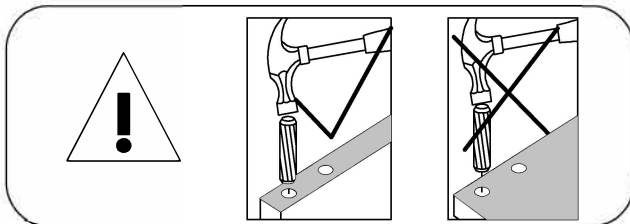
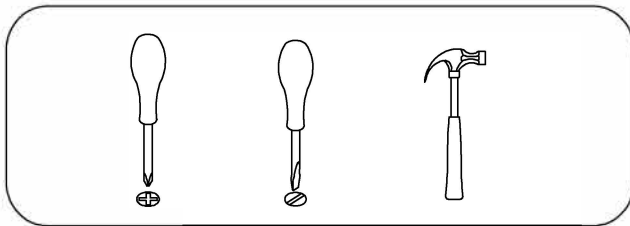

TIPS FOR FITTING CAM-LOCKS AND CAM-PILLARS

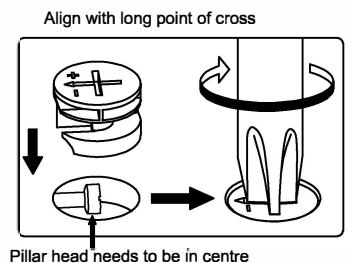
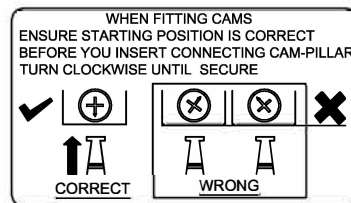

CAM-PILLAR

Tighten until shoulder is flush with panel. Do not overtighten or undertighten (see example below)

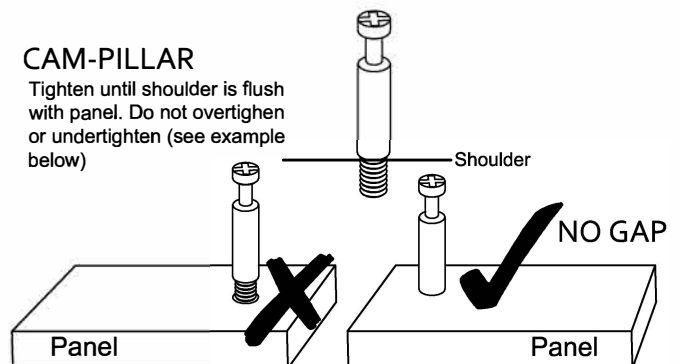

Bookshelf Lena

STEP 1

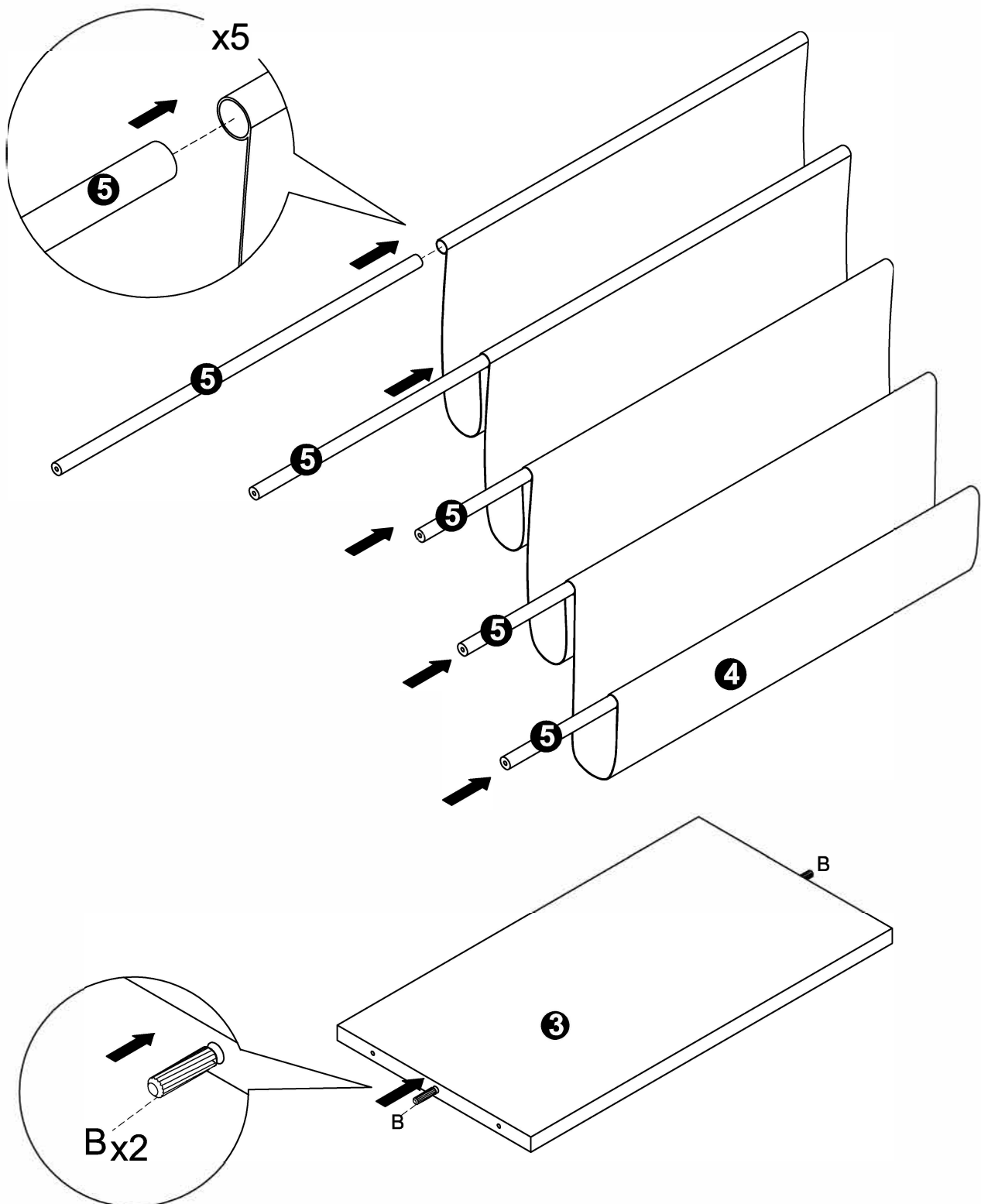

Bookshelf Lena

STEP 2

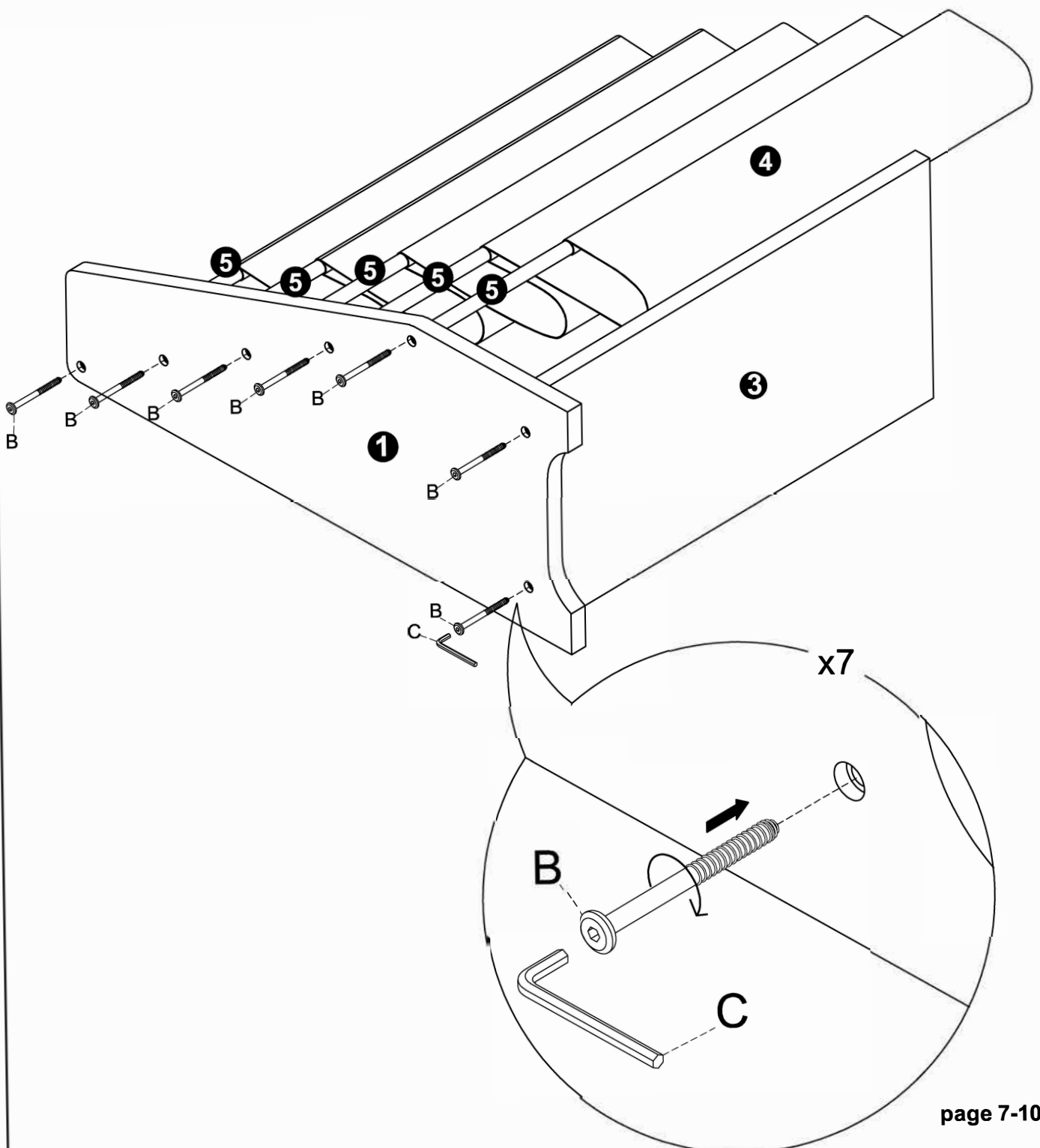

Bookshelf Lena

STEP 3

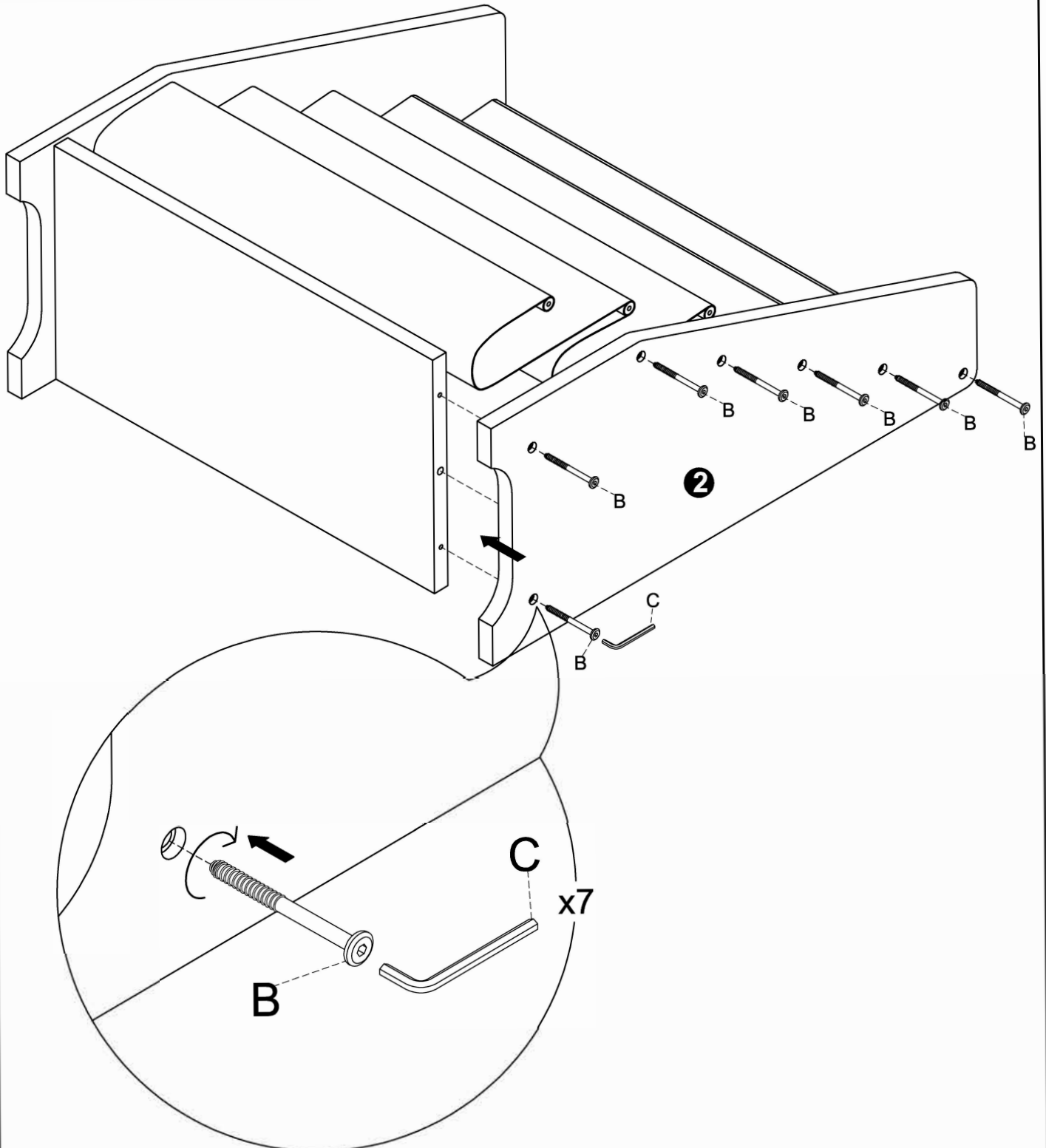

Bookshelf Lena

STEP 4

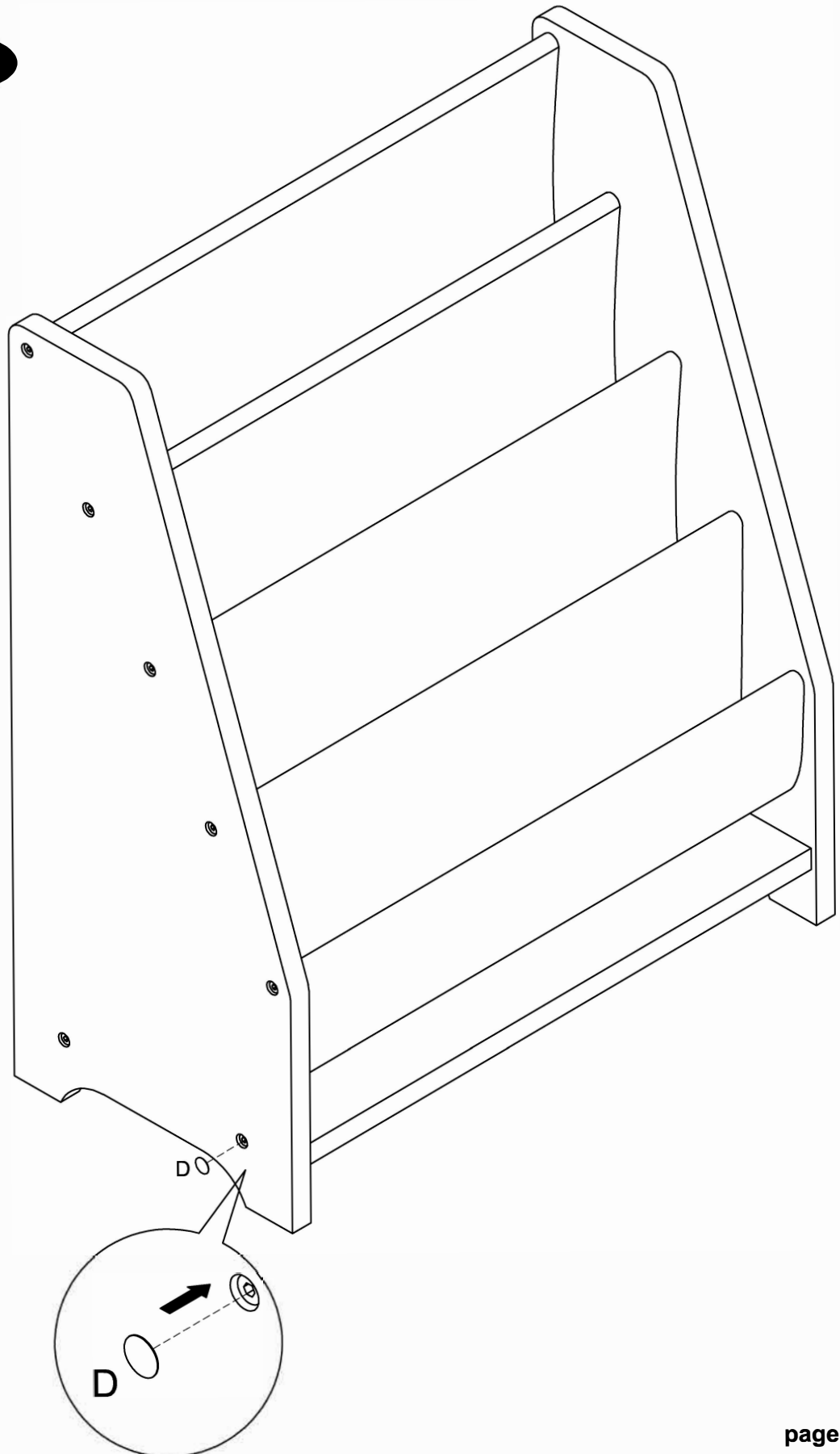

Bookshelf Lena

STEP 5

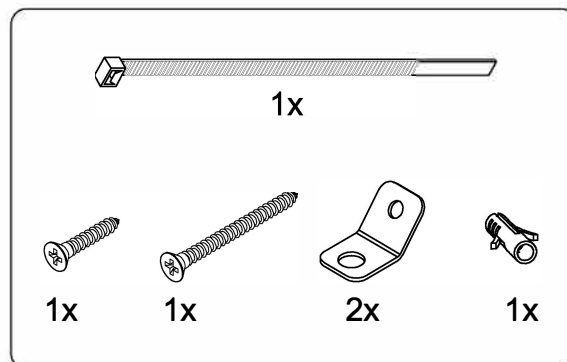
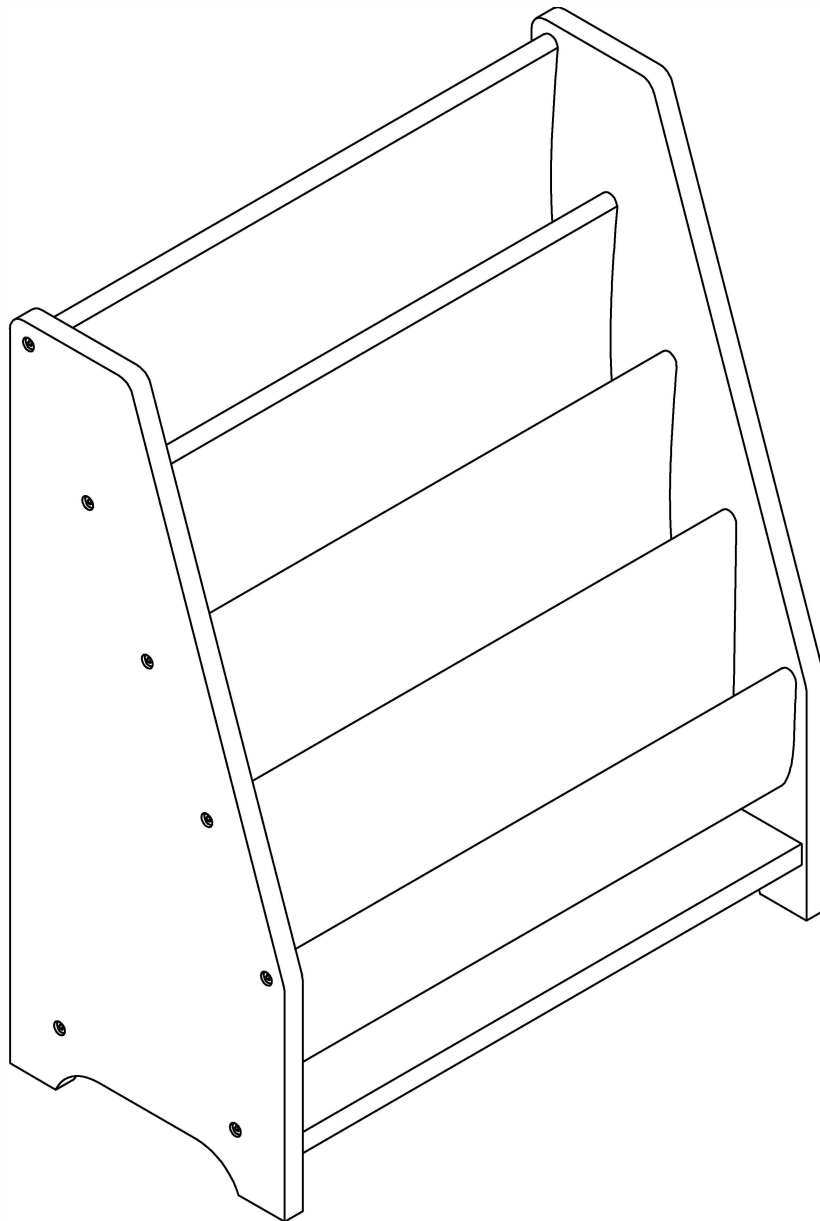

Safety tip: Please attach the desk to the wall using the hardware provided.